

## Installation

## S17316 - 15W LED CCT Microwave Gear Tray

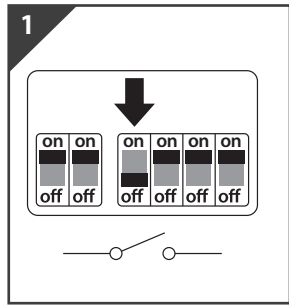

1 Switch OFF at mains supply before installing

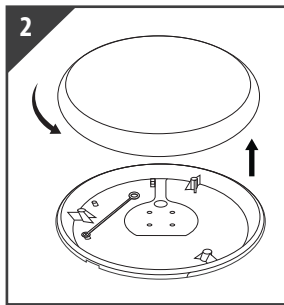

2 Hold the base securely and twist to unlock and remove the diffuser

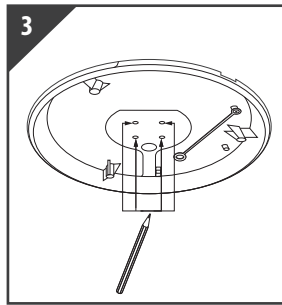

3 Ensure product is located in the correct location and mark the fixing surface

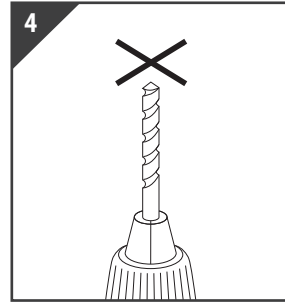

4 Use correct drill bit to drill screw holes

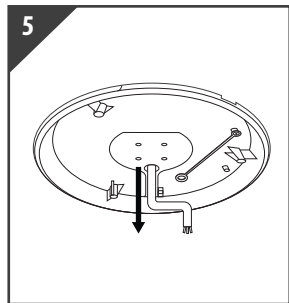

5 Pull power supply through hole in the base plate

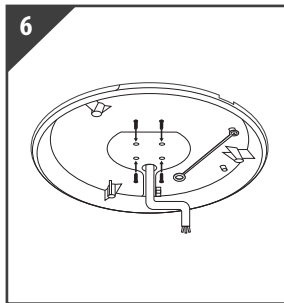

6 Install the fixing screws to the base plate

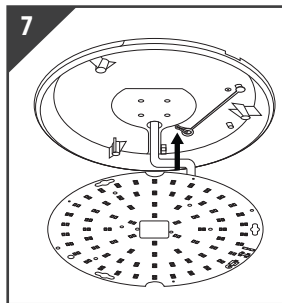

7 Attach safety belt to gear tray

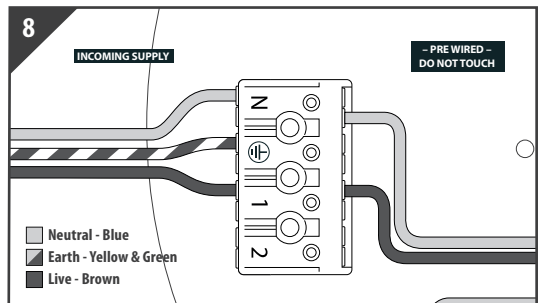

8 Press the individual terminal and insert the correct incoming supply before releasing the terminal to secure. The product MUST be earthed

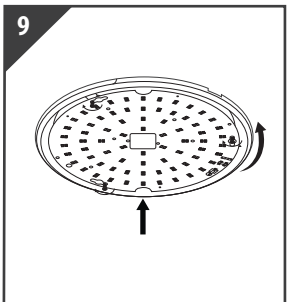

9 Align gear tray with screws and tighten

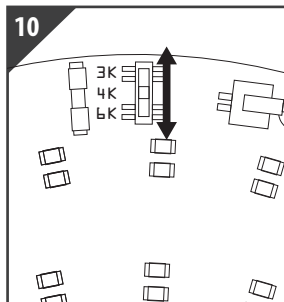

10 Use the CCT selection switch on the gear tray to select the desired colour temperature

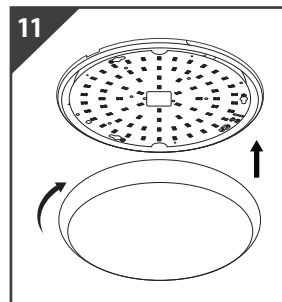

11 Push and twist the diffuser back into place

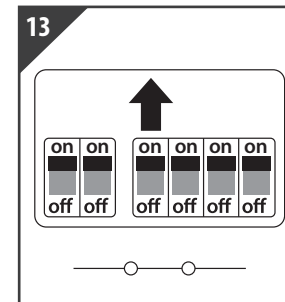

13 Return power. Switch ON at mains supply

## Packaging Information

	SIZE(CM)	N.W/pc (KGS)	G.W.(KGS)	Q'TY(PCS)
Carton	52*43*27	0.25	7.2	20

	CTNS	Q'TY(PCS)	VOLUME(CBM)
20" standard container	400	8000	28
40" standard container	865	17300	58

